

## Soft Wired Starter Sockets

### AT A GLANCE...

- Suitable for: Starting the soft wired circuit
- Colours: Black & White

**“Easy as ECD®”**

- Used to hardwire into at the start of a soft wired circuit.
- Side entry – 20 Amp.
- Compatible with the ECD Soft Wiring System.
- Standard colours are Black & White (White only for ECDSWSSJ).
- Starter Socket Plate (ECDSSP) is typically used for mounting on walls or visible surfaces in readily accessible areas.
- Starter Socket Junction Box (ECDSSWSSJ) is typically used for mounting in false floor or ceiling spaces where not visible or readily accessible.
- Test Plugs (ECDSWTP) are available for testing soft wired circuits.
- Products comply with AS/NZS61535:2011 – refer approval no. GMA-515333.

**ECDSWPWE**



**ECDSWSSJWE**



**ECDSWPBK**



ESTABLISHED 1979

**Electric Cable Duct Systems P/L**

Phone: 1300 123 ECD (323)

Fax: 1300 372 825

Email: [info@ecd.net.au](mailto:info@ecd.net.au)

website: [www.ecd.net.au](http://www.ecd.net.au)

ABN 80005544105

## ASSEMBLY DIAGRAM STARTER SOCKETS

### ECDSSP

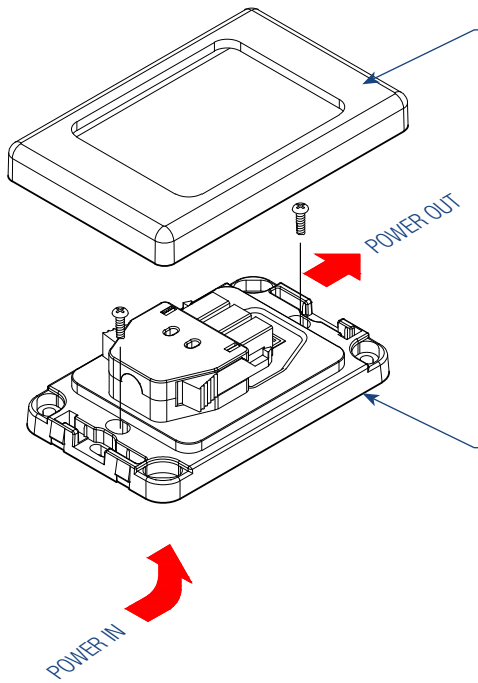

### ECDSSJ

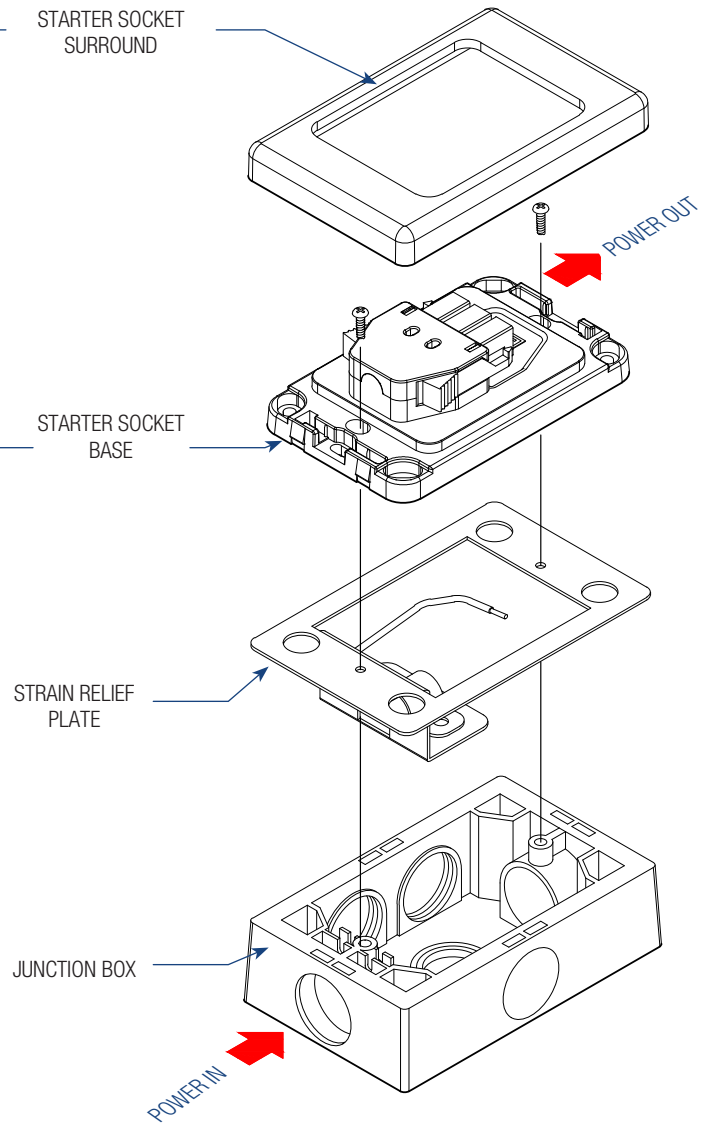

### PARTS LIST

DESCRIPTION	PART NO.	COLOUR
Starter Socket on plate (20 Amp side entry)	ECDSSP	Nominate (see below)
Starter Socket Junction Box (20 Amp side entry)	ECDSSJWE	White

Nominate Colour/Finish: BK=Black, WE=White

Note: All ECD soft wiring must be installed by a licenced electrical contractor as per AS/NZ3000 Wiring Regulations